

# Proposed 114 Street (92 Avenue to 96 Avenue) Roadway Improvements

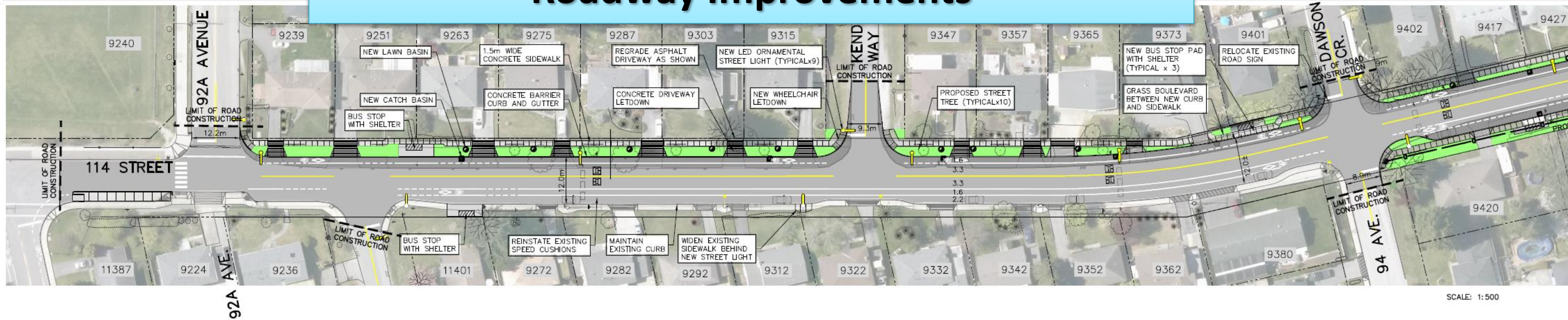

SCALE: 1:500

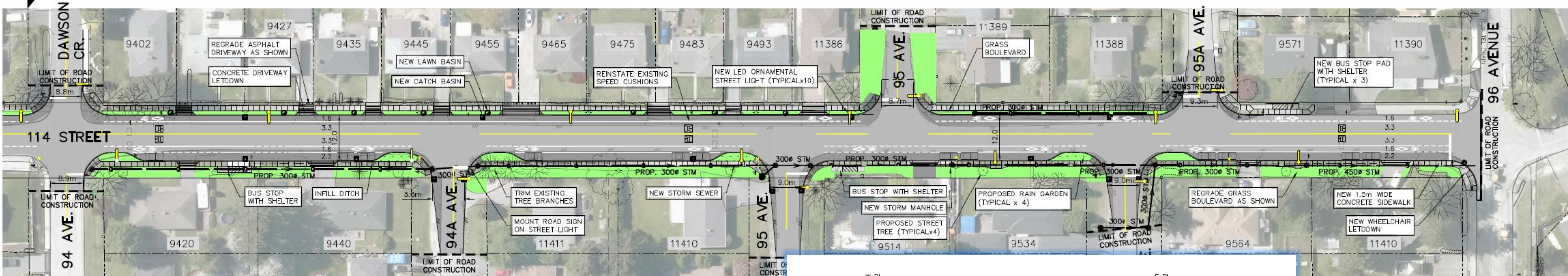

- Scope of Work:**
- Install new storm main and infill ditches
  - Concrete barrier curb and gutter
  - 1.5m wide concrete sidewalk
  - Bus stop improvements
  - Roadway re-paving and widening
  - Dedicated bike lanes both sides (street parking on east side only)
  - New LED street lighting
  - Install drainage swales following storm water "Best Management Practices" (BMP's)
  - Grassed boulevard strip with street trees (locations subject to change)

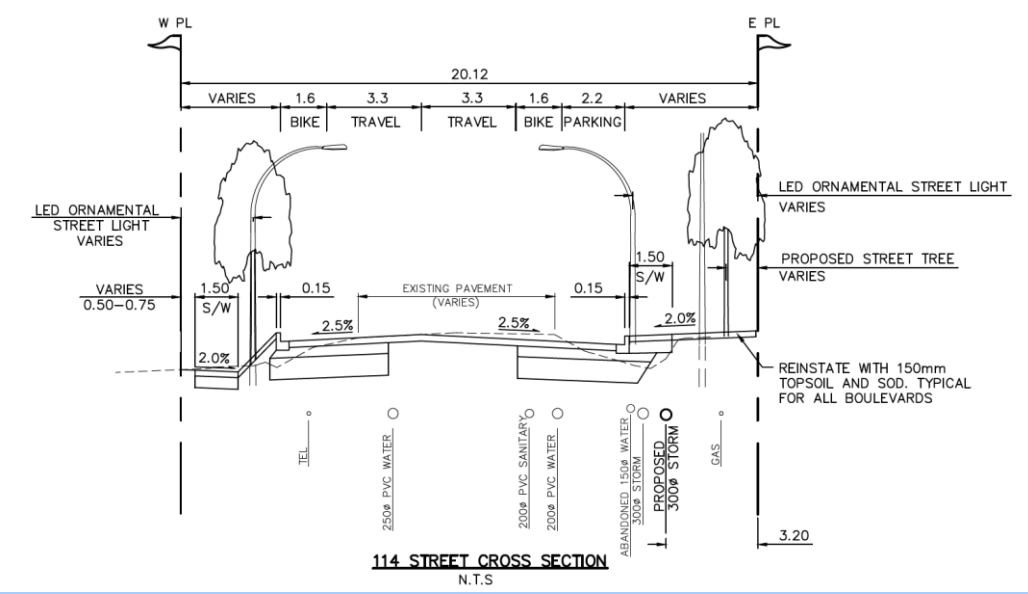

	FULL DEPTH ASPHALT MILL AND REPAVE
	ROAD WIDENING
	CONCRETE SIDEWALK
	ASPHALT DRIVEWAY